



THE MOST COMPLETE UNIVERSAL SENSOR IN A COMPACT 50X50 MM HOUSING

- Sensors with red, infrared LED or LASER emission
- Background suppression from 3 cm to 2 m
- Polarized retroreflective up to 20 m
- Multivoltage 24-240Vac/24-60Vdc with Relay output
- NPN/PNP output NO-NC configuration

APPLICATIONS

- Processing and Packaging machinery
- Conveyor lines, material handling

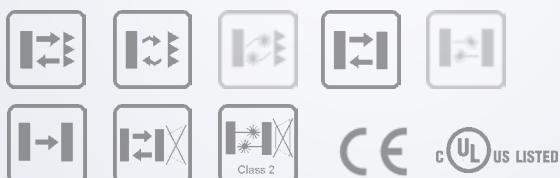

S62		
Through beam		0...25 m
Retroreflective (on R2 reflector)		0,1...13 m
Polarized retroreflective		0,1...8 m
Diffuse proximity		0,3...20 m (class 2 LASER)
Background suppression		short 0...900 mm, long 0...2000 mm
		0...900 mm (class 2 LASER)
		short 30...300 mm
		medium 60...600 mm
		long 60...1200 mm
		very long 200...2000 mm
		short LASER 30...150 mm (class 2 LASER)
		long LASER 50...350 mm (class 2 LASER)
Power supply	Vdc	10...30 V
	Vac	
	Vac/dc	24/240 Vac/24...60 Vdc
Output	PNP	•
	NPN	•
	NPN/PNP	•
	relay	•
	other	
Connection	cable	•
	connector	•
	pig-tail	
Approximate dimensions (mm)		18x50x50
Housing material		ABS
Mechanical protection		IP67

TECHNICAL DATA

Power supply	10 ... 30 Vdc (mod. S62...2/5) 24...240 Vac/ 24...60 Vdc (mod. S62...1)
Ripple	2 Vpp max. (mod. S62...2/5), 10% max. (mod. S62...1)
Consumption (output current excluded)	30 mA max. (mod. S62...2/5) 3 VA max. (mod. S62...1)
Light emission	red LED 640 nm (mod. S62-PA...A/B/C/G/M01/M05/M11/M15) IR LED 880 nm (mod. S62-PA...M21/M25/M31/M35) red Laser 645...665 nm (mod. S62-PL)
Setting	sensitivity adjustment trimmer
Operating mode	mono-turn LIGHT/DARK trimmer (mod. S62...RX/PN)
Indicators	yellow OUTPUT LED green STABILITY LED, POWER LED (S62...G)
Output	PNP or NPN N.O./N.C. (mod. S62...PP/NN); NPN/PNP (mod. S62...PN); electromechanical SPDT 250 Vac/30 Vdc (mod. S62...RX)
Output current	100 mA max. (mod. S62...2/5), 2 A max. (mod. S62...1)
Saturation voltage	2 V max. (mod. S62...2/5)
Response time	25 ms (mod. S62...1) 1,5 ms (mod. S62...M3x) 1 ms (mod. S62...2/5-F/G/M2x) 500 µs (mod. S62-PA...2/5-A/B/C/M0x/M1x) 200 µs (mod. S62-PL...B/C/M11) 140 µs (mod. S62-PL...M01)
Switching frequency	20 Hz (mod. S62...1) 330 Hz (mod. S62...M3x) 500 Hz (mod. S62...2/5-F/G/M2x) 1 kHz (mod. S62-PA...2/5-A/B/C/M0x/M1x) 2,5 kHz (mod. S62-PL...B/C/M11) 3,5 kHz (mod. S62-PL...M01)
Connection	M12 4-pole connector, 2 m Ø 4 mm cable vers., 2 m Ø 5 mm cable vers.
Dielectric strength	500 Vac 1 min., between electronics and housing
Insulation resistance	>20 MΩ 500 Vdc, between electronics and housing
Mechanical protection	IP67
Ambient light rejection	According to EN 60947-5-2
Vibrations	0.5 mm amplitude, 10 ... 55 Hz frequency, for each axis (EN60068-2-6)
Shock resistance	11ms (30G) 6 shock for every axis (EN60068-2-27)
Housing material	ABS
Lens material	PMMA window, polycarbonate lens
Operating temperature	-10 ... 55 °C
Storage temperature	-20 ... 70 °C
Weight	40 g max. conn. vers., 90 max. cable vers.

DIMENSIONS

Background suppression

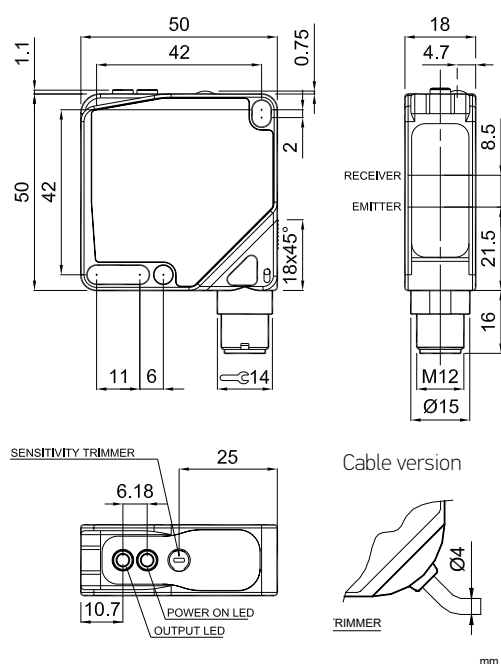

Laser version

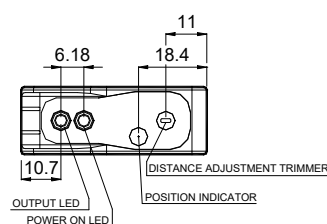

Led version

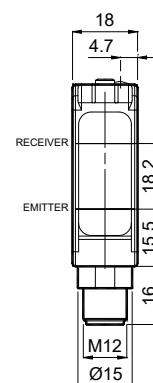
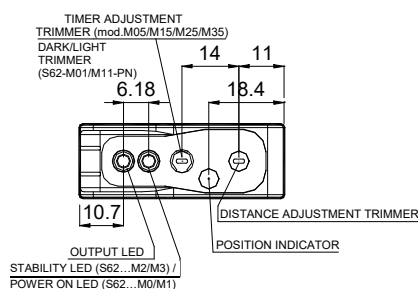

CONNECTIONS

VDC MODELS

M12 CONNECTOR

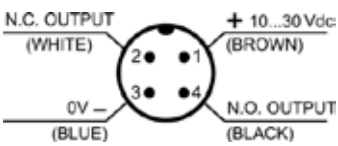
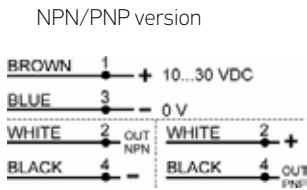
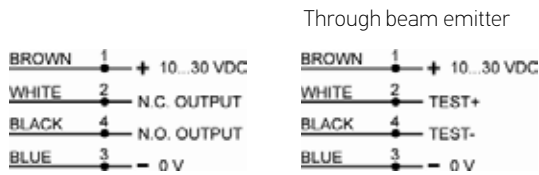

VAC MODELS

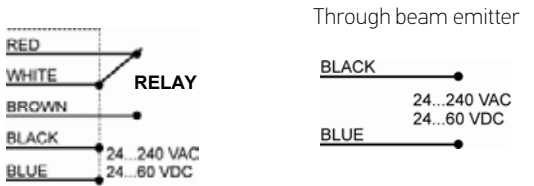

INDICATORS AND SETTINGS

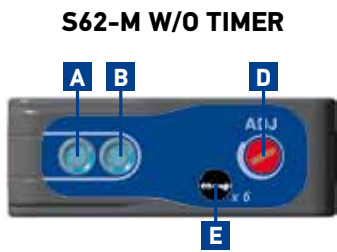
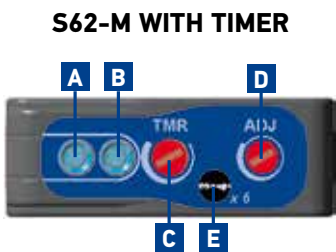
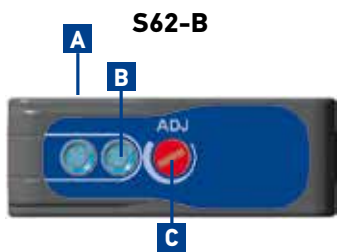

- A** Output status LED
- B** Stability LED or Power ON LED (laser vers.)
- C** Timer adjustment trimmer

- D** Distance adjustment trimmer
- E** Geared numeric scale
- F** M12 connector output
- G** Cable output

DETECTION DIAGRAMS OF MODELS WITH LED EMISSION

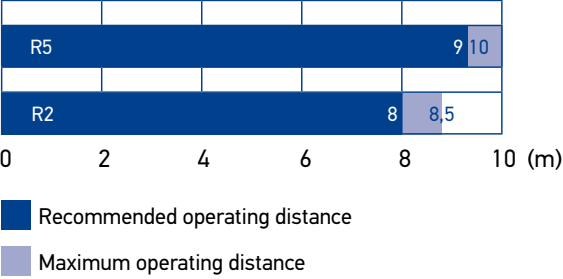
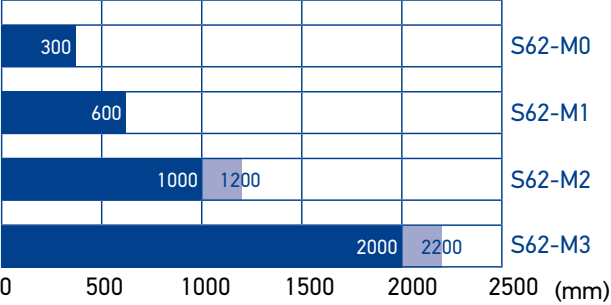
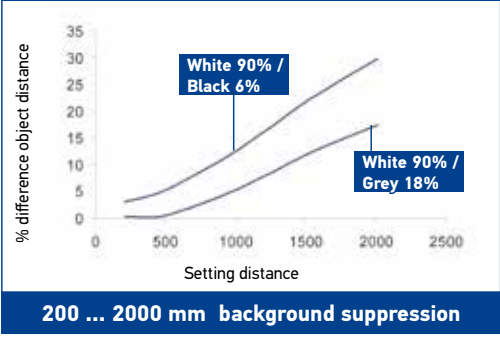
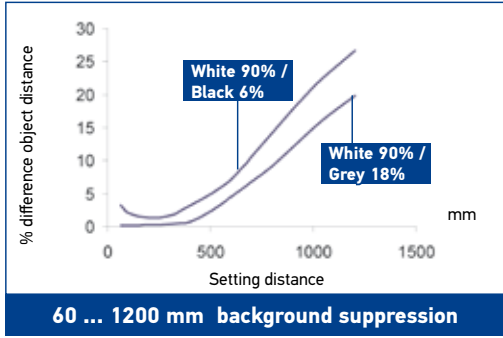
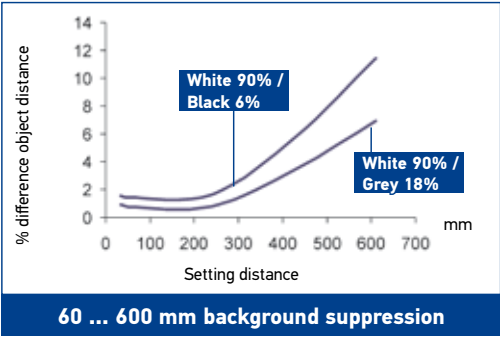
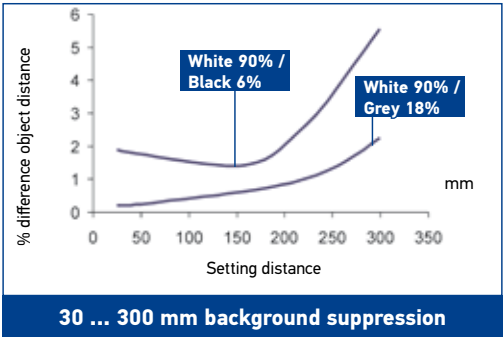
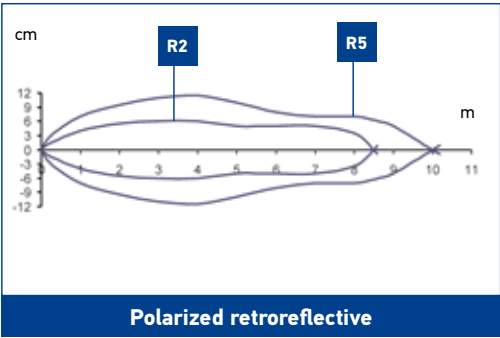

DETECTION DIAGRAMS OF MODELS WITH LASER EMISSION

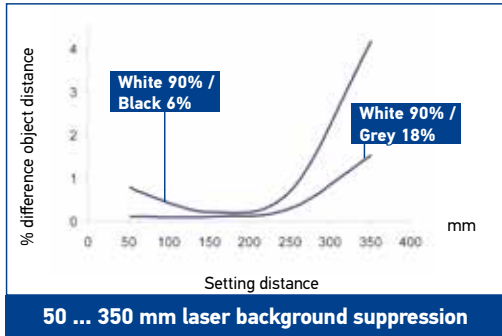
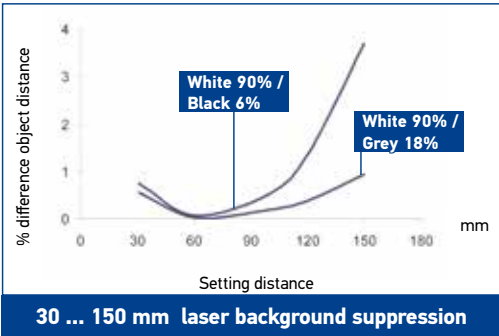
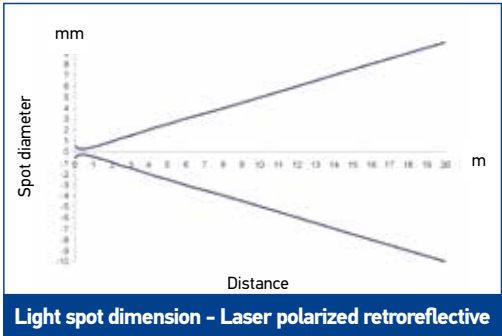
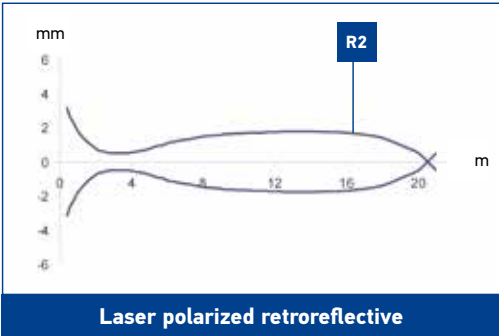

Reflector operating distances (m)				
R1	R2	R6	R7 / R20	R8
0.3 ... 16	0.3 ... 20	0.4 ... 22	0.3 ... 22	0.2 ... 2

The use of the RT3970 reflecting tape is suggested.

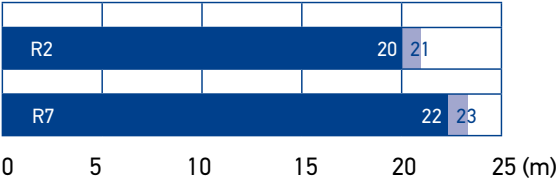
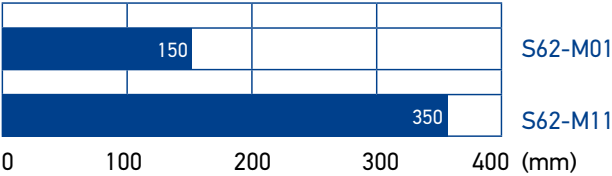

- Recommended operating distance
- Maximum operating distance

MODEL SELECTION AND ORDER INFORMATION

OPTIC FUNCTION	EMISSION	CONNECTION	SETTING	OUTPUT	MODEL	ORDER No.	
Retroreflective	LED (red 640nm)	2m Cable	sensitivity trimmer (mono turn)	PNP/NPN	S62-PA-2-A01-PN	956211240	
		M12 Connector		PNP/NPN	S62-PA-5-A01-PN	956211310	
		Vac relay	mono-turn light/dark trimmer	Relay	S62-PA-1-A01-RX	956211180	
Polarized retroreflective	LED (red 640nm)	2m Cable	sensitivity trimmer (mono-turn)	PNP/NPN	S62-PA-2-B01-PN	956211250	
		M12 Connector		PNP	S62-PA-2-B01-PP	956211010	
				NPN	S62-PA-5-B01-NN	956211020	
				PNP/NPN	S62-PA-5-B01-PN	956211320	
			PNP	S62-PA-5-B01-PP	956211000		
		Vac relay	mono-turn light/dark trimmer	Relay	S62-PA-1-B01-RX	956211190	
	LASER	M12 Connector	mono-turn light/dark trimmer	NPN	S62-PL-5-B01-NN	956211100	
				PNP	S62-PL-5-B01-PP	956211110	
Short diffused proximity	LED (red 640nm)	2m Cable	sensitivity trimmer (mono-turn)	NPN	S62-PA-2-C01-NN	956211420	
		M12 Connector		PNP/NPN	S62-PA-2-C01-PN	956211260	
				PNP	S62-PA-2-C01-PP	956211380	
				NPN	S62-PA-5-C01-NN	956211500	
				PNP/NPN	S62-PA-5-C01-PN	956211330	
		PNP		S62-PA-5-C01-PP	956211460		
	Vac relay	mono-turn light/dark trimmer	Relay	S62-PA-1-C01-RX	956211200		
	LASER	2m Cable	sensitivity trimmer (mono turn)	NPN	S62-PL-2-C01-NN	956211440	
		M12 Connector		PNP	S62-PL-2-C01-PP	956211400	
				NPN	S62-PL-5-C01-NN	956211520	
				PNP	S62-PL-5-C01-PP	956211480	
				NPN	S62-PA-2-C11-NN	956211430	
PNP/NPN		S62-PA-2-C11-PN		956211270			
Long diffused proximity	LED (red 640nm)	2m Cable	sensitivity trimmer (mono turn)	PNP	S62-PA-2-C11-PP	956211390	
		M12 Connector		NPN	S62-PA-5-C11-NN	956211510	
				PNP/NPN	S62-PA-5-C11-PN	956211340	
				PNP	S62-PA-5-C11-PP	956211470	
				Vac relay	mono-turn light/dark trimmer	Relay	S62-PA-1-C11-RX
		Through beam receiver		-	2m Cable	sensitivity trimmer (mono turn)	NPN
M12 Connector	PNP/NPN		S62-PA-2-F01-PN		956211290		
	PNP		S62-PA-2-F01-PP		956211410		
	NPN		S62-PA-5-F01-NN		956211530		
	PNP/NPN		S62-PA-5-F01-PN		956211360		
PNP	S62-PA-5-F01-PP		956211490				
Through beam emitter	LED (red 640nm)	Vac relay	mono-turn light/dark trimmer	Relay	S62-PA-1-F01-RX	956211220	
		2m Cable	sensitivity trimmer (mono turn)	-	S62-PA-2-G00-XG	956211300	
		M12 Connector			S62-PA-5-G00-XG	956211370	
		Vac relay			S62-PA-1-G00-XX	956211230	
Background suppression (short distance)	LED (red 640nm)	2m Cable			6 turns distance adjustment trimmer	PNP/NPN	S62-PA-2-M01-PN
		M12 Connector	PNP	S62-PA-2-M01-PP		956201841	
			NPN	S62-PA-5-M01-NN		956201811	
			PNP/NPN	S62-PA-5-M01-PN		956211350	
	LASER	M12 Connector	4 turns distance adjustment trimmer	PNP	S62-PA-5-M01-PP	956201831	
				NPN	S62-PA-5-M05-NN	956201801	
				PNP	S62-PA-5-M05-PP	956201821	
				NPN	S62-PL-5-M01-NN	956211120	
Background suppression (medium distance)	LED (red 640nm)	M12 Connector	6 turns distance adjustment trimmer	PNP	S62-PL-5-M01-PP	956211130	
				NPN	S62-PA-2-M11-PP	956201891	
				NPN	S62-PA-5-M11-NN	956201861	
				PNP	S62-PA-5-M11-PP	956201881	
	LASER	M12 Connector	6 turns distance adjustment trimmer	NPN	S62-PA-5-M15-NN	956201851	
				PNP	S62-PA-5-M15-PP	956201871	
				NPN	S62-PL-5-M11-NN	956211140	
				PNP	S62-PL-5-M11-PP	956211150	
Background suppression (long distance)	LED (infrared 880nm)	2m Cable	6 turns distance adjustment trimmer	PNP	S62-PA-2-M21-PP	956201940	
		M12 Connector		NPN	S62-PA-5-M21-NN	956201910	
				PNP	S62-PA-5-M21-PP	956201900	
				NPN	S62-PA-5-M25-NN	956201930	
Background suppression (very long distance)		M12 Connector	6 turns distance adjustment trimmer	PNP	S62-PA-5-M25-PP	956201920	
				PNP	S62-PA-2-M31-PP	956211050	
				NPN	S62-PA-5-M31-NN	956211060	
				PNP	S62-PA-5-M31-PP	956211070	
			timer adjustment trimmer	NPN	S62-PA-5-M35-NN	956211080	
				PNP	S62-PA-5-M35-PP	956211090	

ACCESSORIES

ST-504

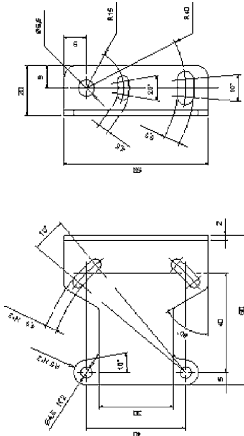

ST-5020

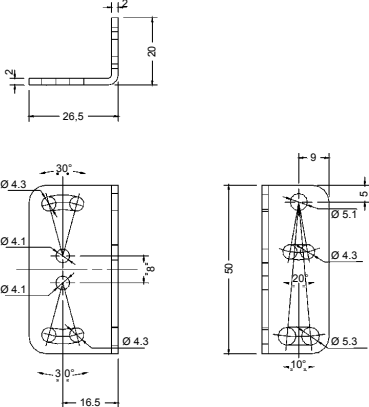

ST-5021

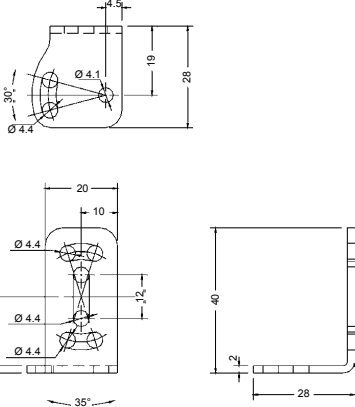

ST-5053

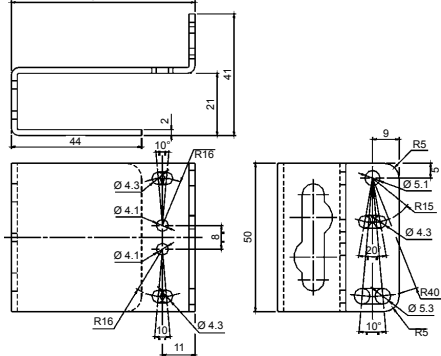

ST-5054

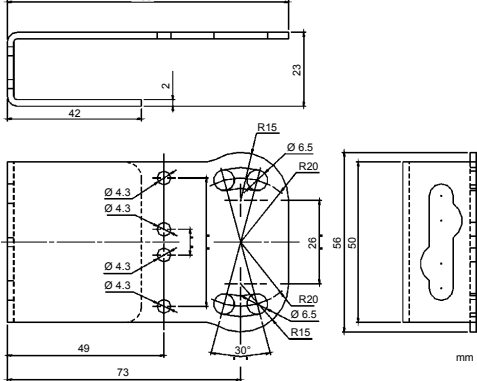

ST-5018

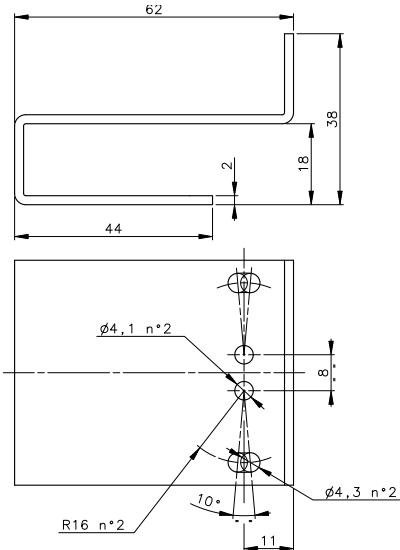

ST-5019

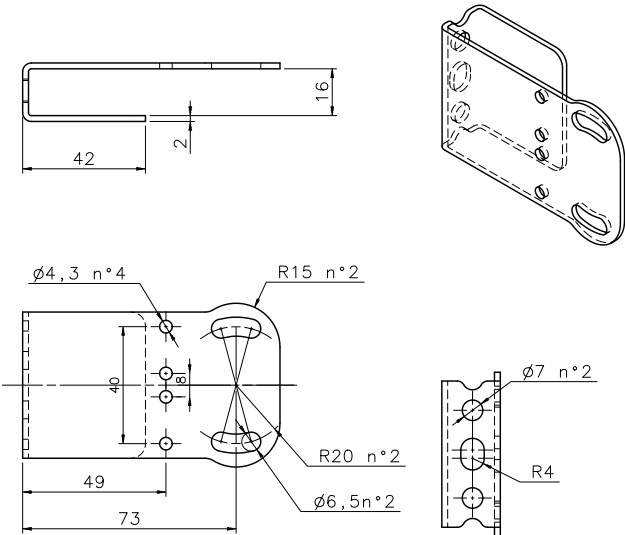

MODEL	DESCRIPTION	ORDER No.
ST-5018	protective bracket	95ACC5310
ST-5019	protective bracket	95ACC5320
ST-5020	mounting bracket	95ACC5330
ST-5021	mounting bracket	95ACC5340
ST-504	mounting bracket	95ACC2820
ST-5053	protective bracket	95ACC2410
ST-5054	protective bracket	95ACC2420
JOINT-S62	protective bracket with jointed support	95ACC2430

CABLES

TYPE	DESCRIPTION	LENGTH	MODEL	ORDER No.
Axial M12 Connector	4-pole, grey, P.V.C.	3 m	CS-A1-02-G-03	95A251380
		5 m	CS-A1-02-G-05	95A251270
		7 m	CS-A1-02-G-07	95A251280
		10 m	CS-A1-02-G-10	95A251390
	4-pole, P.U.R.	2 m	CS-A1-02-R-02	95A251540
		5 m	CS-A1-02-R-05	95A251560
Radial M12 Connector	4-pole, grey, P.V.C.	3 m	CS-A2-02-G-03	95A251360
		5 m	CS-A2-02-G-05	95A251240
		7 m	CS-A2-02-G-07	95A251245
		10 m	CS-A2-02-G-10	95A251260
	4-pole, P.U.R.	2 m	CS-A2-02-R-02	95A251550
		5 m	CS-A2-02-R-05	95A251570
Radial M12 Connector with LED (for PNP N.O. sensors)	4-pole, grey, P.V.C.	3 m	CS-A2-12-G-03	95A251400
		5 m	CS-A2-12-G-05	95A251350
		10 m	CS-A2-12-G-10	95A251370
Axial M12 Connector	4-pole, shielded, black, P.V.C.	3 m	CV-A1-22-B-03	95ACC1480
		5 m	CV-A1-22-B-05	95ACC1490
		10 m	CV-A1-22-B-10	95ACC1500
		15 m	CV-A1-22-B-15	95ACC2070
		25 m	CV-A1-22-B-25	95ACC2090
Radial M12 Connector		3 m	CV-A2-22-B-03	95ACC1540
		5 m	CV-A2-22-B-05	95ACC1550
		10 m	CV-A2-22-B-10	95ACC1560
Axial M12 Connector	4-pole, U.L., black, P.V.C.	3 m	CS-A1-02-U-03	95ASE1120
		5 m	CS-A1-02-U-05	95ASE1130
		10 m	CS-A1-02-U-10	95ASE1140
		15 m	CS-A1-02-U-15	95ASE1150
		25 m	CS-A1-02-U-25	95ASE1160
	4-pole, black	Connector- not cabled	CS-A1-02-B-NC	G5085002
Radial M12 Connector		Connector- not cabled	CS-A2-02-B-NC	G5085003

DATALOGIC PRODUCT OFFERING



Sensors



Hand Held
scanners



Mobile Computers



Laser Marking
Systems



Safety Laser
Scanner



Vision
Systems



Stationary
Industrial
Scanners



Safety Light
Curtains

Rev. 01,07/2016

The company endeavours to continuously improve and renew its products; for this reason the technical data and contents of this catalogue may undergo variations without prior notice. For correct installation and use, the company can guarantee only the data indicated in the instruction manual supplied with the products. Product and Company names and logos referenced may be either trademarks or registered trademarks of their respective companies. We reserve the right to make modifications and improvements.